

2250T Performance Windows



Milwaukee
Plate Glass

Casement • Projected • Fixed

2 1/4" Deep Framing
Flush Aligned Sash
Full Thermal Separation
Dual Sash Weatherstrip
Egress Windows
Crimped & Sealed Corners
Anodized & Painted Finishes
LEED Compliant

Performance Tested:
Class CW PG 100-AP
Class CW PG 90-C
Frame CRF 60
Thermal U Value 0.49

Available Factory Glazed
Qualified Installation
Full Product Warranty

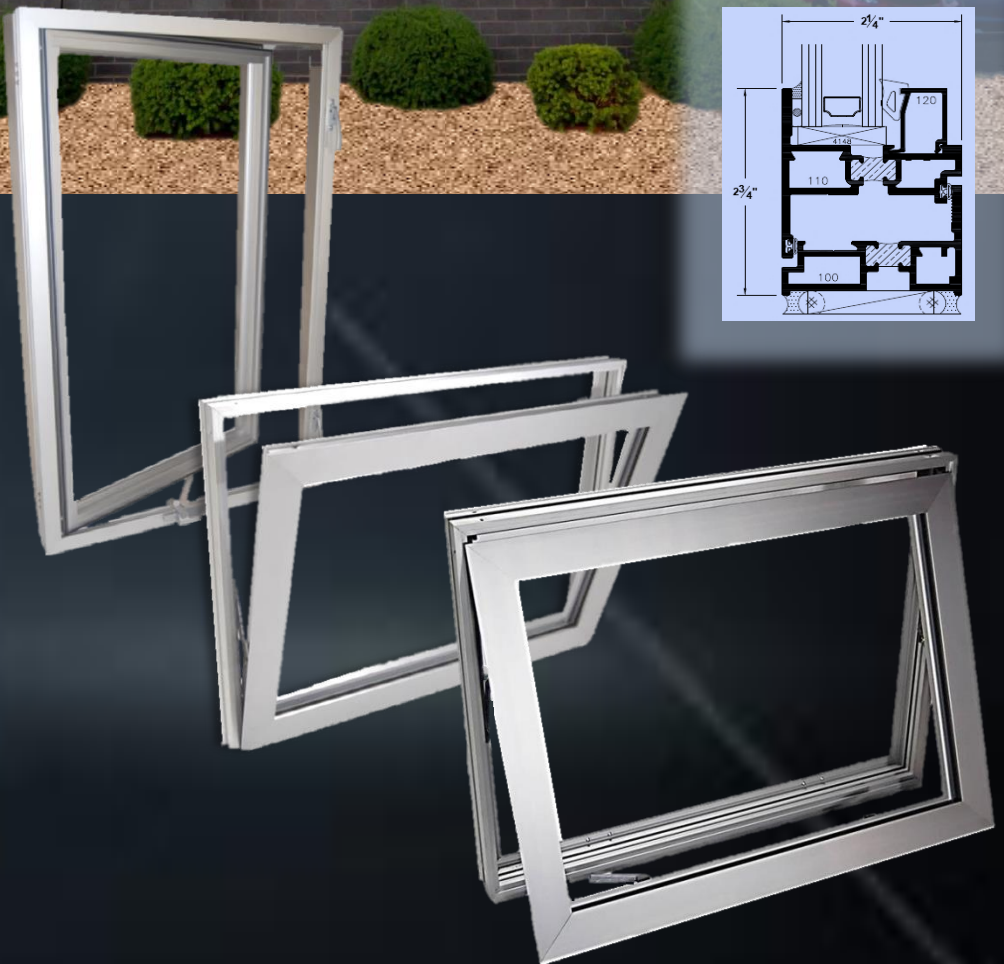
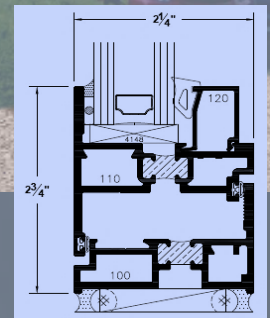

Milwaukee Plate Glass, 11233 W. Greenfield Ave., West Allis, WI 53214

414-771-5660

www.milwaukeeplateglass.com